



ELECTRIC STRIKE

MAGNETIC LOCK



DS-002

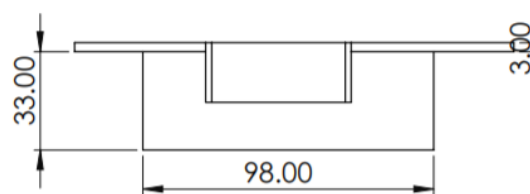
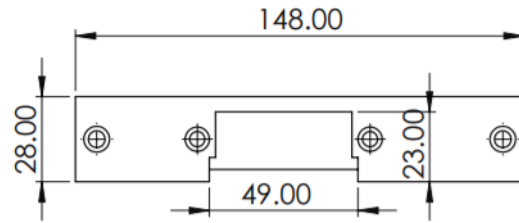

SPECIFICATION

DS-002
 • Use with access and door entry systems
 • Suitable for wooden doors
 • 12VDC
 • Current: 120mA
 • Apply power to lock

FEATURES

DS-002
 • 400kg holding force
 • Fail-safe
 • Mortise face plate only

OTHER PRODUCTS

KPI1000

STE-P

DIMENSIONS

DS-002
 • 150x35x28 (mm)
 • 370g (Boxed)
 • 322g (Unboxed)

CONTENTS

DS-002
 • Door Strike
 • Diode

ML600

DU-GB/PTE



Manufactured by a BSIA Member